



THERMODUL[®]
by Hekos

EN 442

Skirting Board Heating System

Installation Instructions Water Model



Dryzone Ltd

5 Aston quay

Dublin 2

Ireland

+353 1 6708922

info@dryzone.ie

www.dryzone.ie

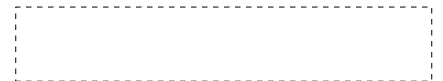



TOOLS REQUIRED

- Chop-Saw – Aluminum Blade
- Expander – 14 mm and 16mm pipes
- Welding torch
- Saw
- Solder joints
- Screwdrivers
- Pliers
- Scissors
- Drill
- Measuring tape
- Tread
- Sandpaper/Steel Brushes

THERMODUL - FIRST FIX INSTRUCTIONS

The pipe layout is similar to the tradition radiator system

Keep pipes 15 mm from the wall and parallel to each other.

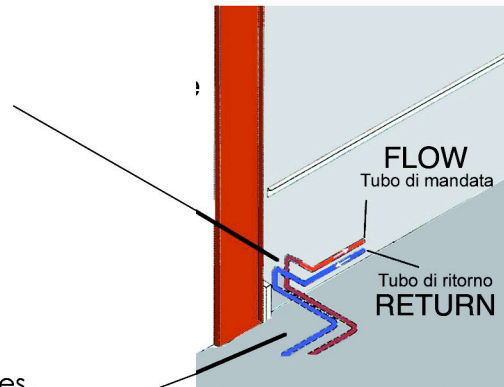

When meeting obstacles such as fireplaces, doors, etc, ensure that there are preinsulated pipes to ensure the continuous run of the circuit.

Distance from doors and other obstacles should be 50 mm

Height from the floor (centre of pipes from finished floor)
 Flow - 70 mm
 Return - 35 mm

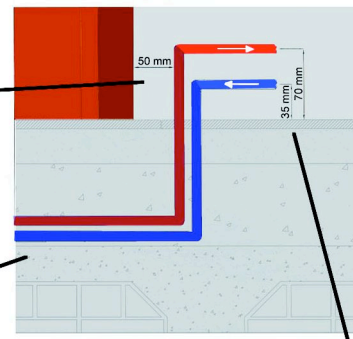



Art. SL – FRONT PLATE



Art. KA – Heating core
(water)

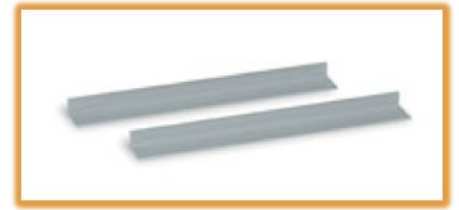

Art. PL – PVC profile



Art. OA External Corner



Art. OS – Terminal

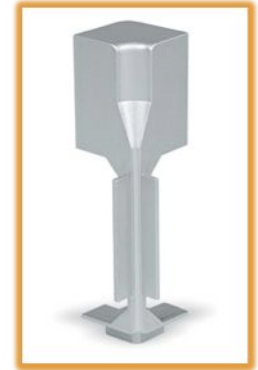

Art. OI – Internal corner



Art.OB – Return Elbow



Art. OC – Corner Elbow



Art. OT - Brackets

THERMODUL COMPONENTS